

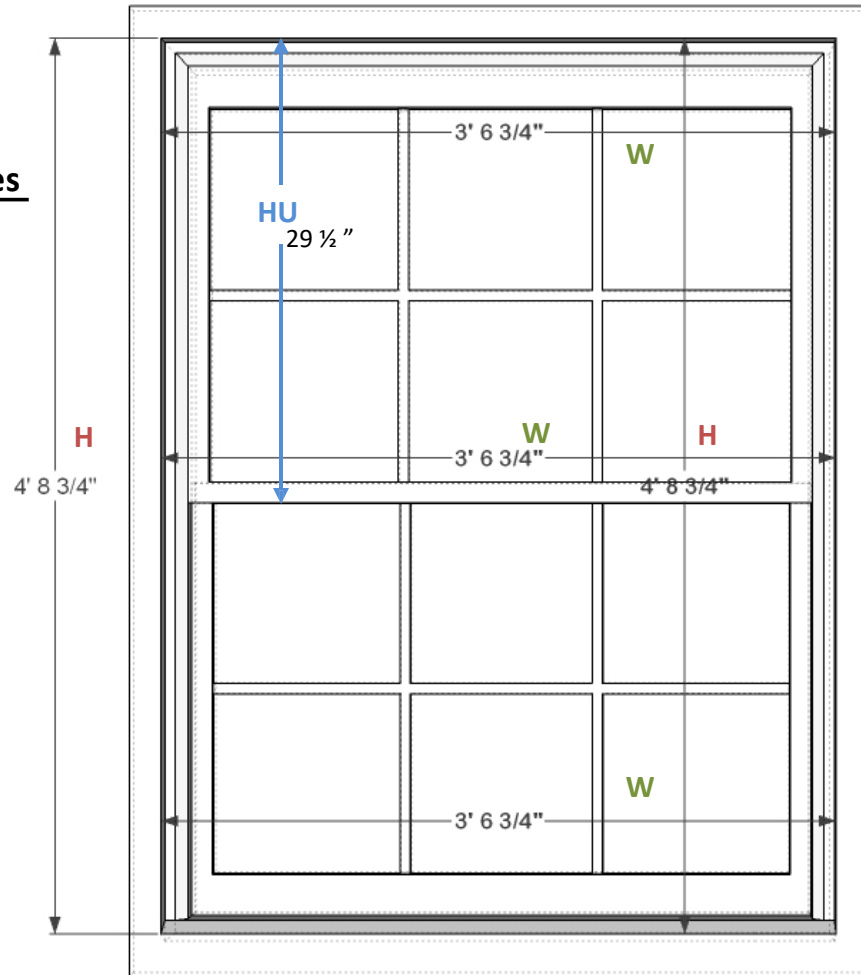

### Measurement Guidelines for QUANTAPANEL® 700 Series

1. Measurements should be taken to the nearest 1/8th inch.
2. Take two (2) measurements of the HEIGHT of the opening and two or three (2 – 3) measurements of the WIDTH as shown in the diagram. Record the smallest WIDTH and smallest HEIGHT to the nearest 1/8th inch.
3. To ensure alignment with the meeting rails of the existing double hung window, measure from the top of the opening to the bottom of the existing meeting rail. Record this value as HEIGHT UPPER [HU] to the nearest 1/8th inch.
4. A Sill Expander is optional; it provides the ability to extend an additional 5/16 inch during installation to square up against the sill.
5. The Installation Methods for the 700 Series is:
  - MAKE SIZE** (we produce to exact tip-tip measurements).
6. The Installation Reference can be used to identify the floor/room/location. This information will be printed on the product label and packaging documents.



ITEM	MODEL (STYLE)	EXISTING OPENING		HEIGHT UPPER (ORIEL CONFIG)	SILL EXPANDER TYPE: 0, 1"	INSTALL METHOD MAKE SIZE	COLOR (NS)	QUANTITY	INSTALLATION REFERENCE
		WIDTH (W)	HEIGHT (H)						
1	700 SERIES 704-DH	32 <sup>3</sup> / <sub>4</sub>	56 <sup>3</sup> / <sub>4</sub>	29 <sup>1</sup> / <sub>2</sub>	1"	MAKE SIZE	WHT	1	KITCHEN

## QUANTAPANEL 704-DH MEASUREMENT GUIDANCE

### For Blind Stop Installation (for Blind Stop measuring less than or equal to 5/8 in.)

1. Take the Opening Measurement, reduce the WIDTH and HEIGHT by 1/8 in. to ensure fit. This would be your MAKE SIZE dimension (tip-to-tip).
2. A 1" sill expander is recommended; this will allow extension of the height an additional 5/16 in. beyond the prescribed MAKE SIZE height.
3. The [HU] is measured from the top of the opening (top of fin) to the bottom of the existing meeting rail. See the drawing for additional detail.

### For Blind Stop Installation (for Blind Stop measuring greater than 3/4 in.)

1. Take the measurement between the Blind Stops.
2. Add 1 3/8 in. to the WIDTH, this would be your MAKE SIZE dimension (tip-to-tip).  
Add 5/8 in. to the HEIGHT, this would be your MAKE SIZE dimension (tip-to-tip).
3. A 1" sill expander is recommended; this will allow extension of the height an additional 5/16 in. beyond the prescribed MAKE SIZE height.
4. The [HU] is measured from the inside of the upper blind stop + 5/8 in. (top of fin) to the bottom of the existing meeting rail.  
See the drawing for additional detail.

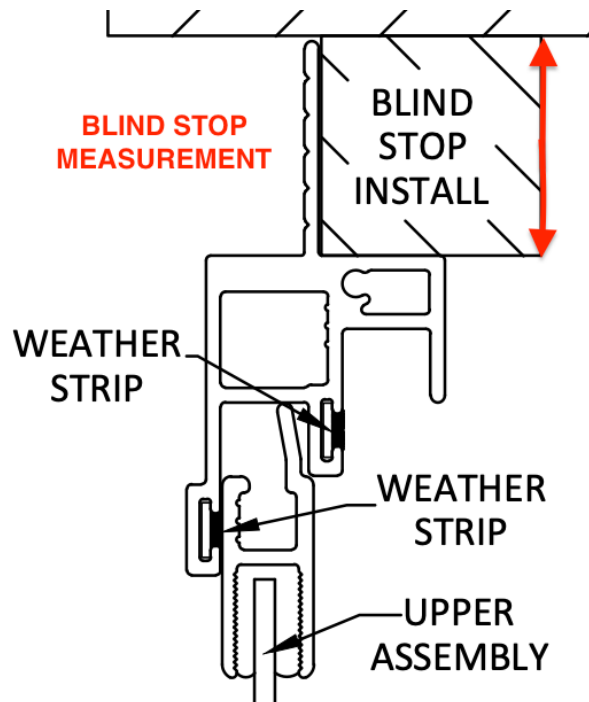

## For Overlap Installation

1. Take the Opening Measurement.
2. Add 1 3/8 in. to the WIDTH, this would be your MAKE SIZE dimension (tip-to-tip).  
Add 5/8 in. to the HEIGHT, this would be your MAKE SIZE dimension (tip-to-tip).
3. A 1" sill expander is recommended; this will allow extension of the height an additional 5/16 in. beyond the prescribed MAKE SIZE height.
4. The [HU] is measured from the top of the opening + 5/8 in. (top of fin) to the bottom of the existing meeting rail.  
See the drawing for additional detail.

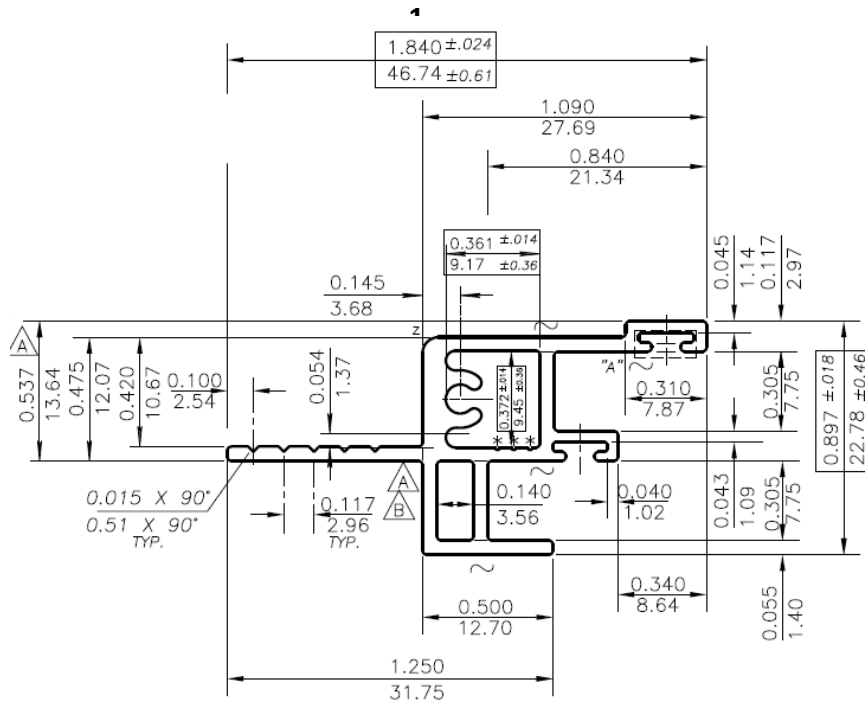
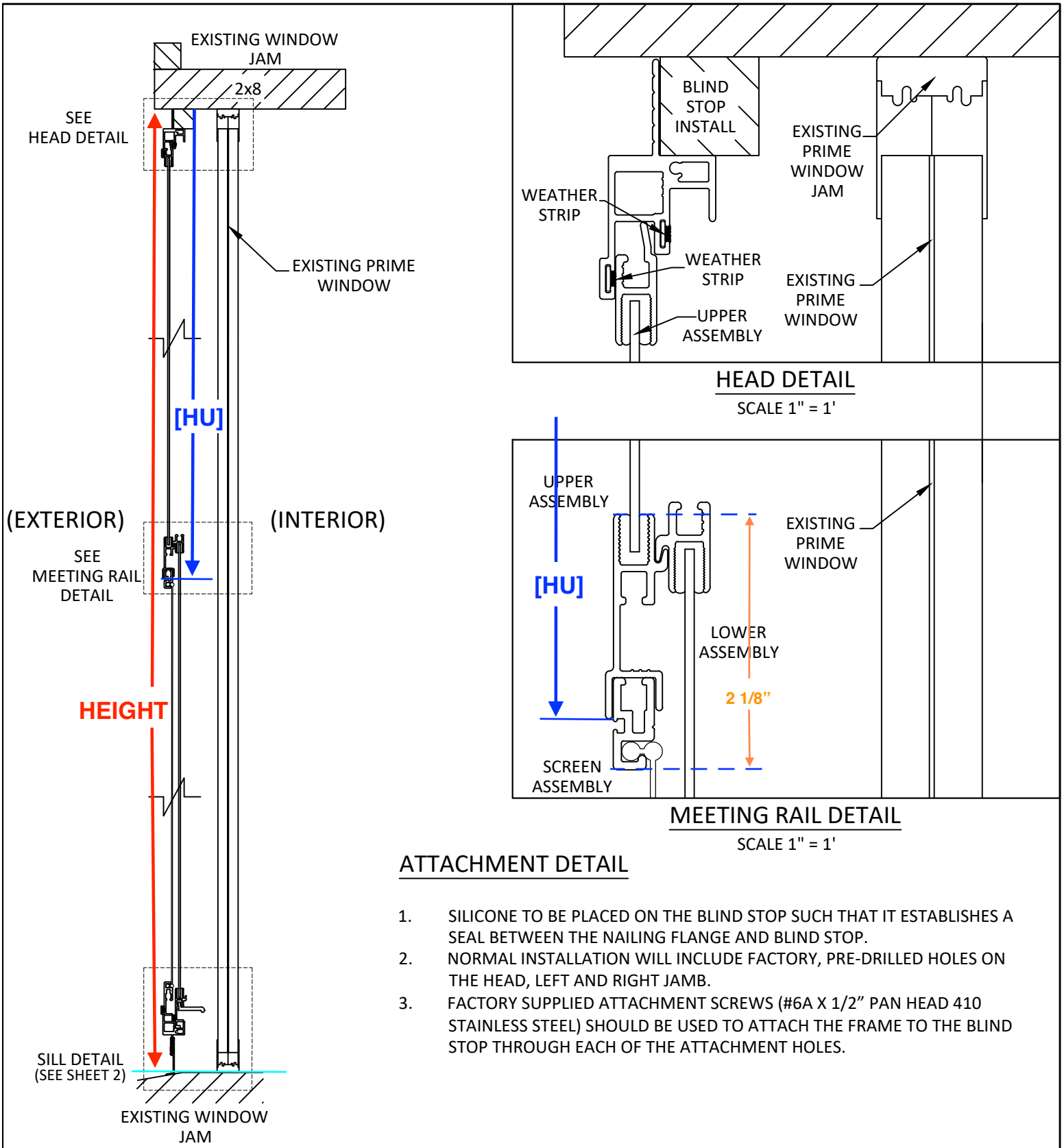

Figure 1: QUANTAPANEL 704- DH IGS Frame Dimensions



**ATTACHMENT DETAIL**

1. SILICONE TO BE PLACED ON THE BLIND STOP SUCH THAT IT ESTABLISHES A SEAL BETWEEN THE NAILING FLANGE AND BLIND STOP.
2. NORMAL INSTALLATION WILL INCLUDE FACTORY, PRE-DRILLED HOLES ON THE HEAD, LEFT AND RIGHT JAMB.
3. FACTORY SUPPLIED ATTACHMENT SCREWS (#6A X 1/2" PAN HEAD 410 STAINLESS STEEL) SHOULD BE USED TO ATTACH THE FRAME TO THE BLIND STOP THROUGH EACH OF THE ATTACHMENT HOLES.

**QUANTAPANEL®**

QP704-DH INSULATING GLASS SYSTEM  
DETAIL SHEET 1 - INSTALLED

NOTES:

DATE  
08/04/2020

SCALE  
1" = 5'

DRAWN BY  
R.A.S.