

#6 x 1/2" STAINLESS STEEL TAP SCREWS (3)

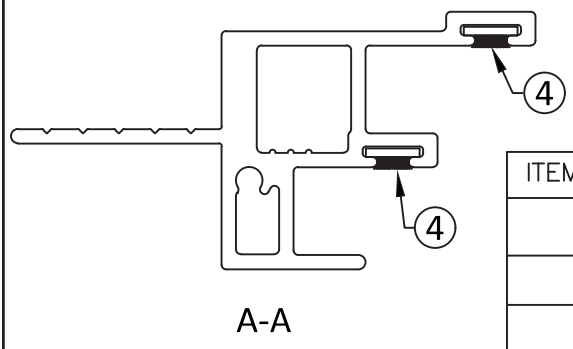

ITEM No.	ITEM	QUANTITY
1	ALUMINUM FRAME EXTENSION 7101	4
2	CORNER KEY	4
3	#6x 3/4" STAINLESS STEEL TAP SCREWS	8
4	0.200" H PILE WEATHERSTRIP WITH CENTER FIN	8

NOTES:

**QUANTAPANEL®**

704-DH INSULATING GLASS SYSTEM  
FRAME ASSEMBLY

DATE  
06/29/2017

SCALE

DRAWN BY

EXISTING  
WINDOW JAM

HEAD DETAIL

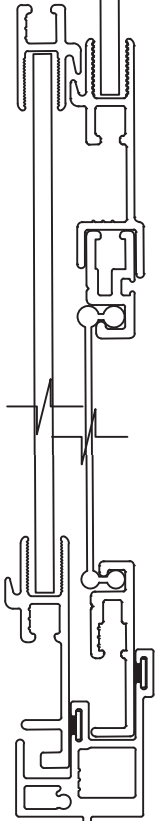
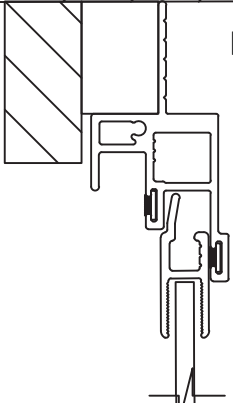

MEETING RAIL DETAIL

SILL DETAIL

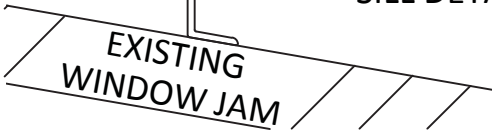

EXISTING  
WINDOW JAM

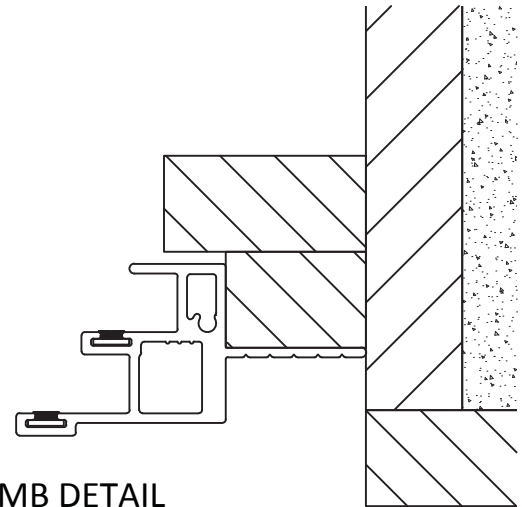

JAMB DETAIL

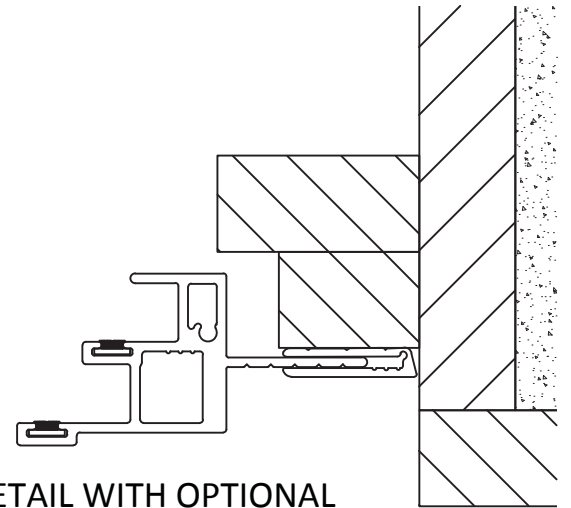

JAMB DETAIL WITH OPTIONAL  
7210-SIDE EXPANDER

**QUANTAPANEL®**

704-DH INSULATING GLASS SYSTEM  
DETAIL - INSTALLED

NOTES:

DATE  
03/01/2018

SCALE

DRAWN BY

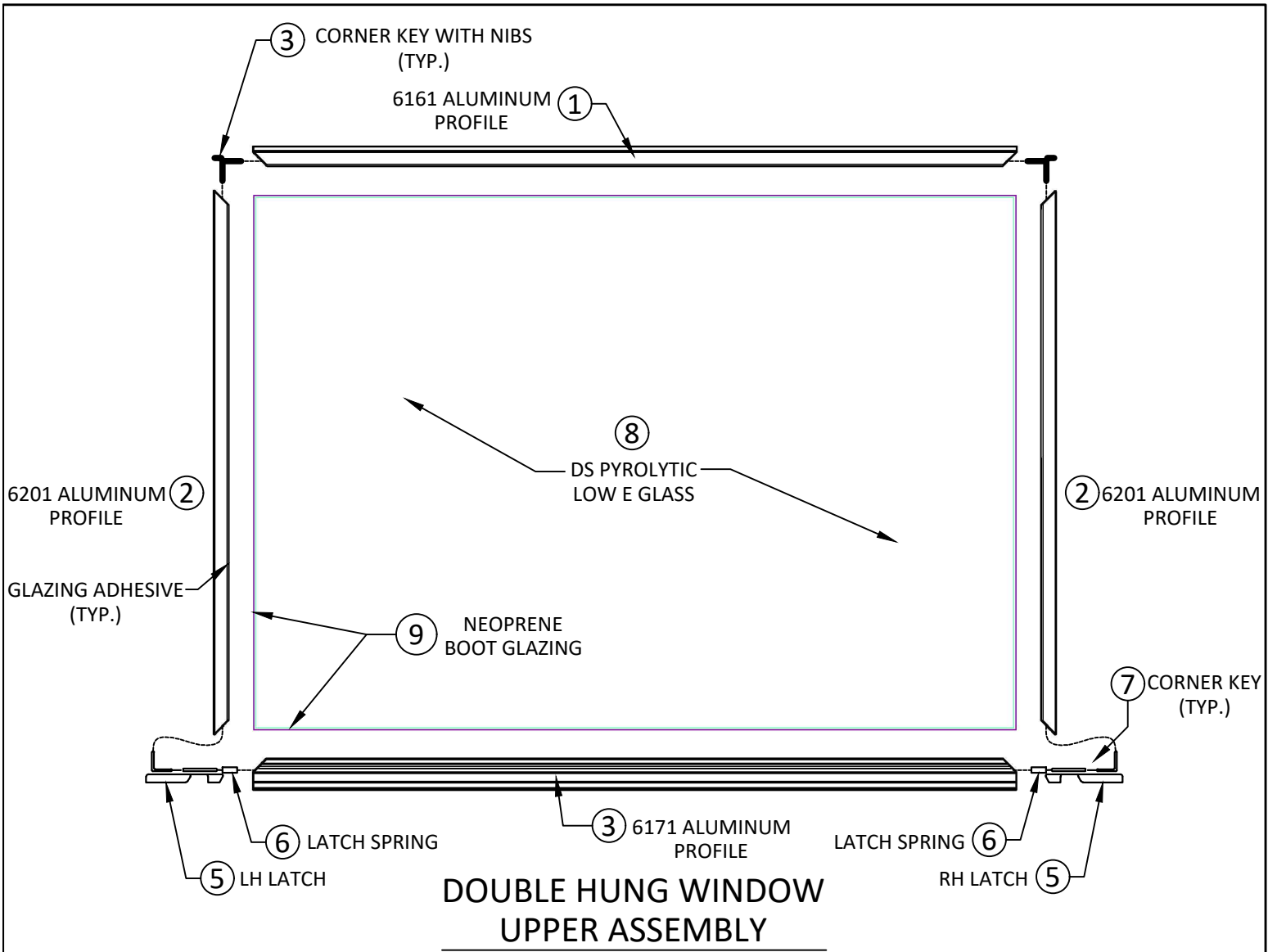

ITEM No.	ITEM	QUANTITY
1	ALUMINUM SASH EXTRUSION 6161 (AS66474)	1
2	ALUMINUM SASH EXTRUSION 6201 (AS65795)	2
3	ALUMINUM SASH EXTRUSION 6171 (AS66473)	1
4	CORNER KEY WITH NIBS	2
5	LATCHES (1 RIGHT HAND, 1 LEFT HAND)	2
6	LATCH SPRINGS	2
7	CORNER KEY	2
8	DS PYROLYTIC LOW E GLASS	1
9	NEOPRENE BOOT GLAZING	1

**QUANTAPANEL®**

QP704-DH INSULATING GLASS SYSTEM  
DOUBLE HUNG  
UPPER ASSEMBLY

NOTES:

DATE  
08/01/2020

SCALE  
1:8

DRAWN BY  
R.A.S.

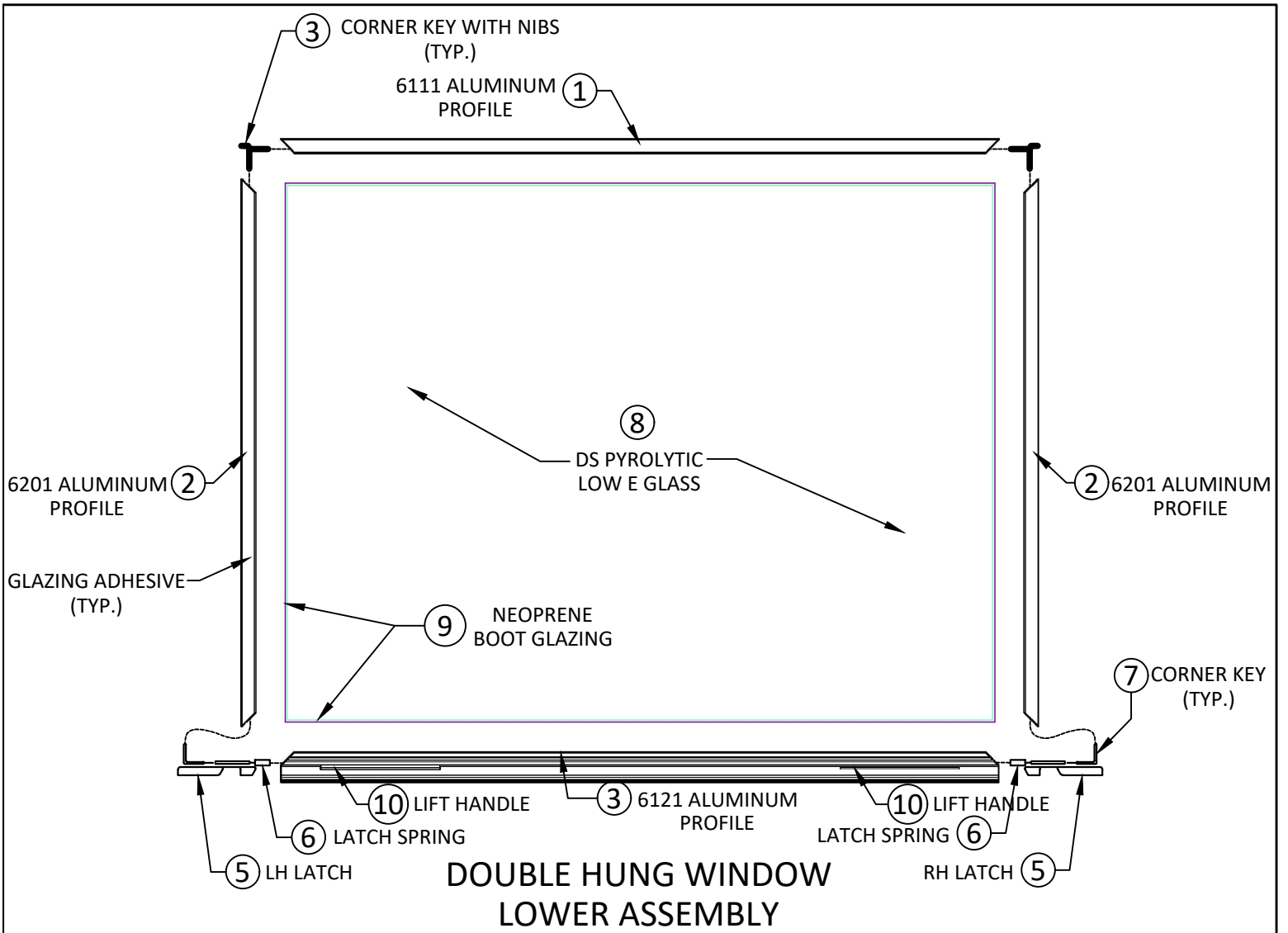

ITEM No.	ITEM	QUANTITY
1	ALUMINUM SASH EXTRUSION 6111 (AS66488)	1
2	ALUMINUM SASH EXTRUSION 6201 (AS65795)	2
3	ALUMINUM SASH EXTRUSION 6121 (AS66489)	1
4	CORNER KEY WITH NIBS	2
5	LATCHES (1 RIGHT HAND, 1 LEFT HAND)	2
6	LATCH SPRINGS	2
7	CORNER KEY	2
8	DS PYROLYTIC LOW E GLASS	1
9	NEOPRENE BOOT GLAZING	1
10	LIFT HANDLE EXTRUSION	2

**QUANTAPANEL®**

QP704-DH INSULATING GLASS SYSTEM  
DOUBLE HUNG  
LOWER ASSEMBLY

NOTES:

DATE  
08/01/2020

SCALE  
1:8

DRAWN BY  
R.A.S.

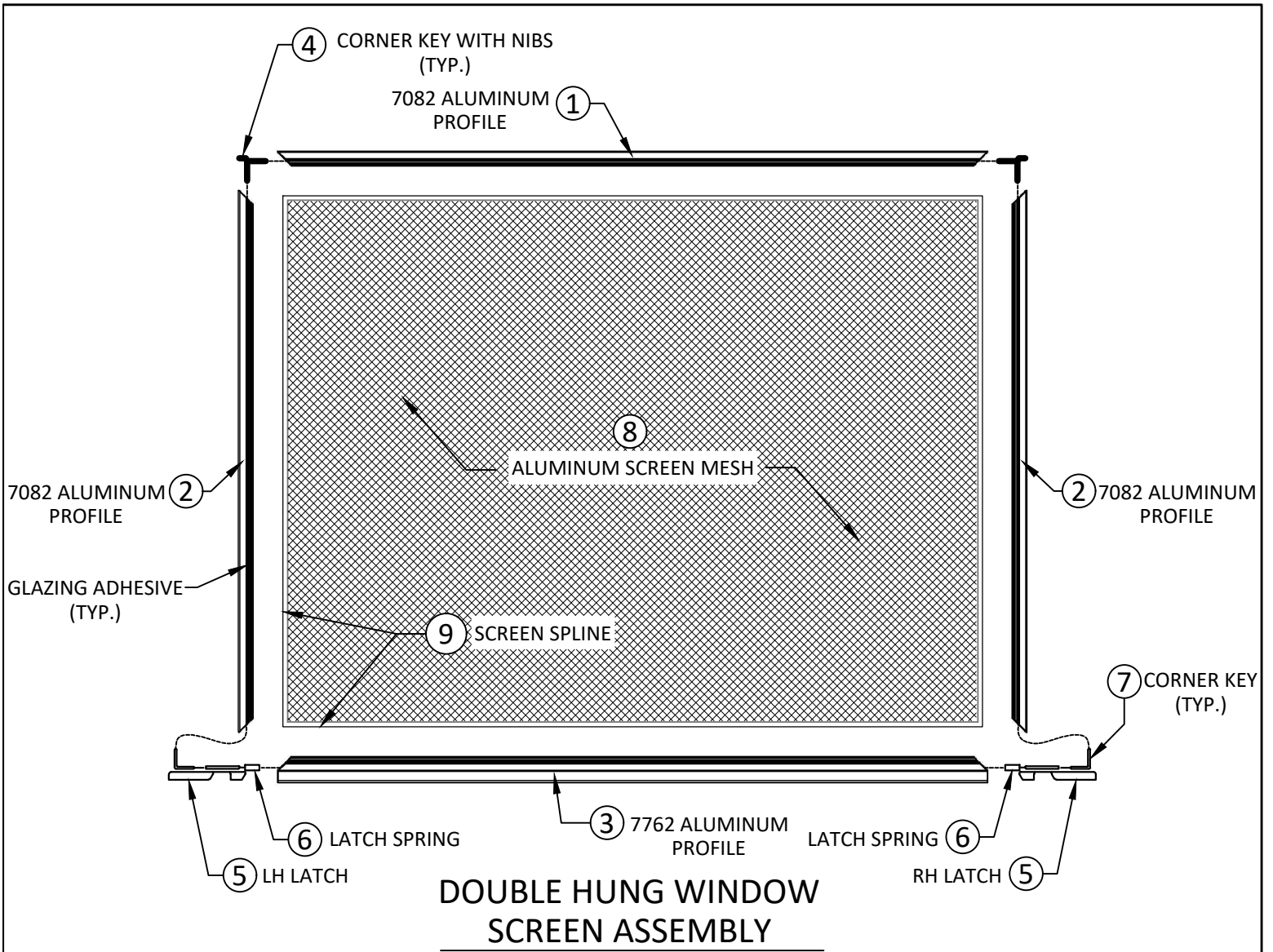

ITEM No.	ITEM	QUANTITY
1	ALUMINUM SASH EXTRUSION ( )	1
2	ALUMINUM SCREEN EXTRUSION ( )	2
3	ALUMINUM SCREEN EXTRUSION 7762 (AS64498)	1
4	CORNER KEY WITH NIBS	2
5	LATCHES (1 RIGHT HAND, 1 LEFT HAND)	2
6	LATCH SPRINGS	2
7	CORNER KEY	2
8	ALUMINUM SCREEN MESH	1
9	SCREEN SPLINE	1

**QUANTAPANEL®**

QP-704DH INSULATING GLASS SYSTEM  
DOUBLE HUNG  
SCREEN ASSEMBLY

NOTES:

DATE  
08/01/2020

SCALE  
1:8

DRAWN BY  
R.A.S.

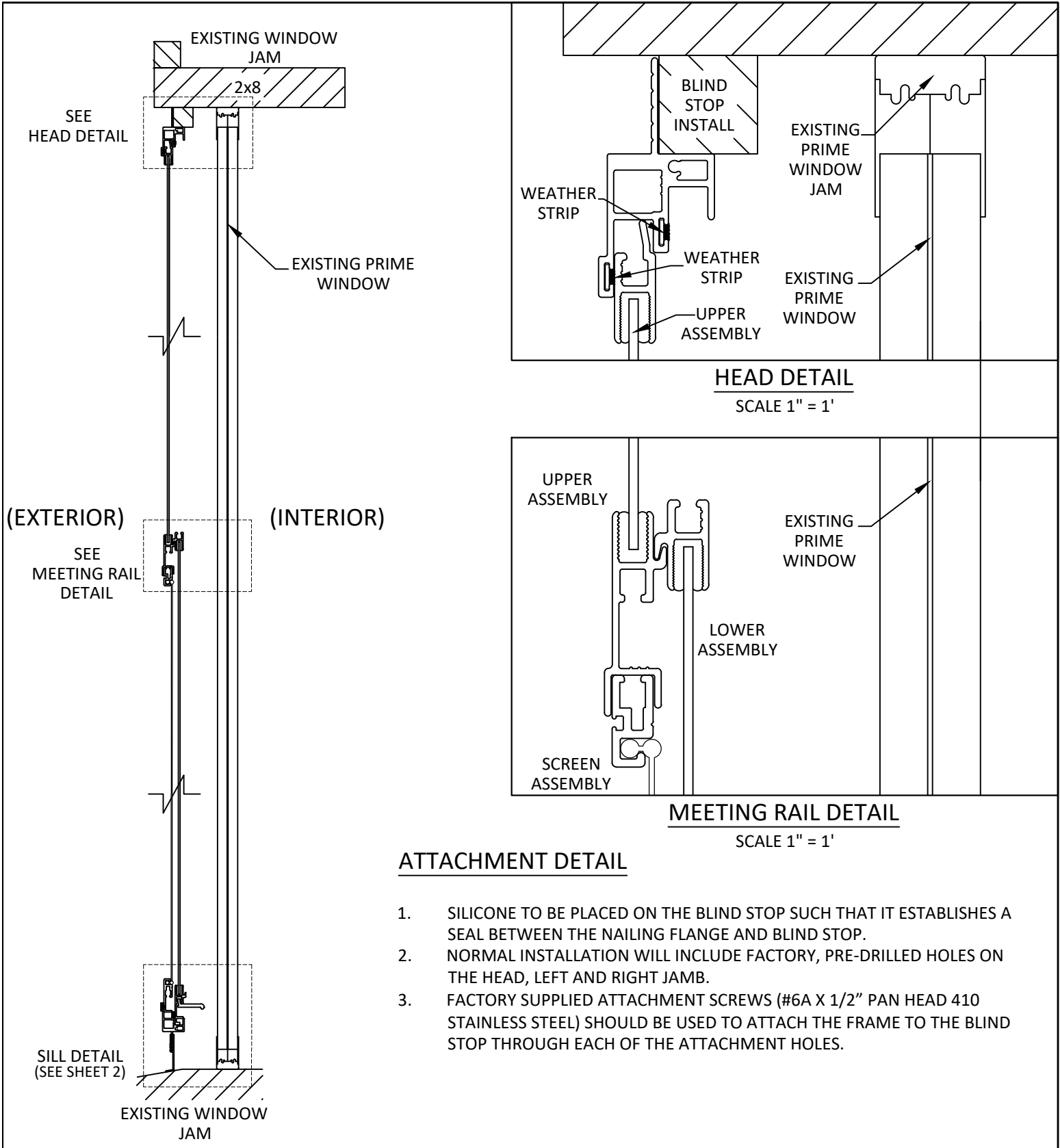

**ATTACHMENT DETAIL**

1. SILICONE TO BE PLACED ON THE BLIND STOP SUCH THAT IT ESTABLISHES A SEAL BETWEEN THE NAILING FLANGE AND BLIND STOP.
2. NORMAL INSTALLATION WILL INCLUDE FACTORY, PRE-DRILLED HOLES ON THE HEAD, LEFT AND RIGHT JAMB.
3. FACTORY SUPPLIED ATTACHMENT SCREWS (#6A X 1/2" PAN HEAD 410 STAINLESS STEEL) SHOULD BE USED TO ATTACH THE FRAME TO THE BLIND STOP THROUGH EACH OF THE ATTACHMENT HOLES.

**QUANTAPANEL®**  
 QP704-DH INSULATING GLASS SYSTEM  
 DETAIL SHEET 1 - INSTALLED

NOTES:

DATE	08/04/2020
SCALE	1" = 5'
DRAWN BY	R.A.S.

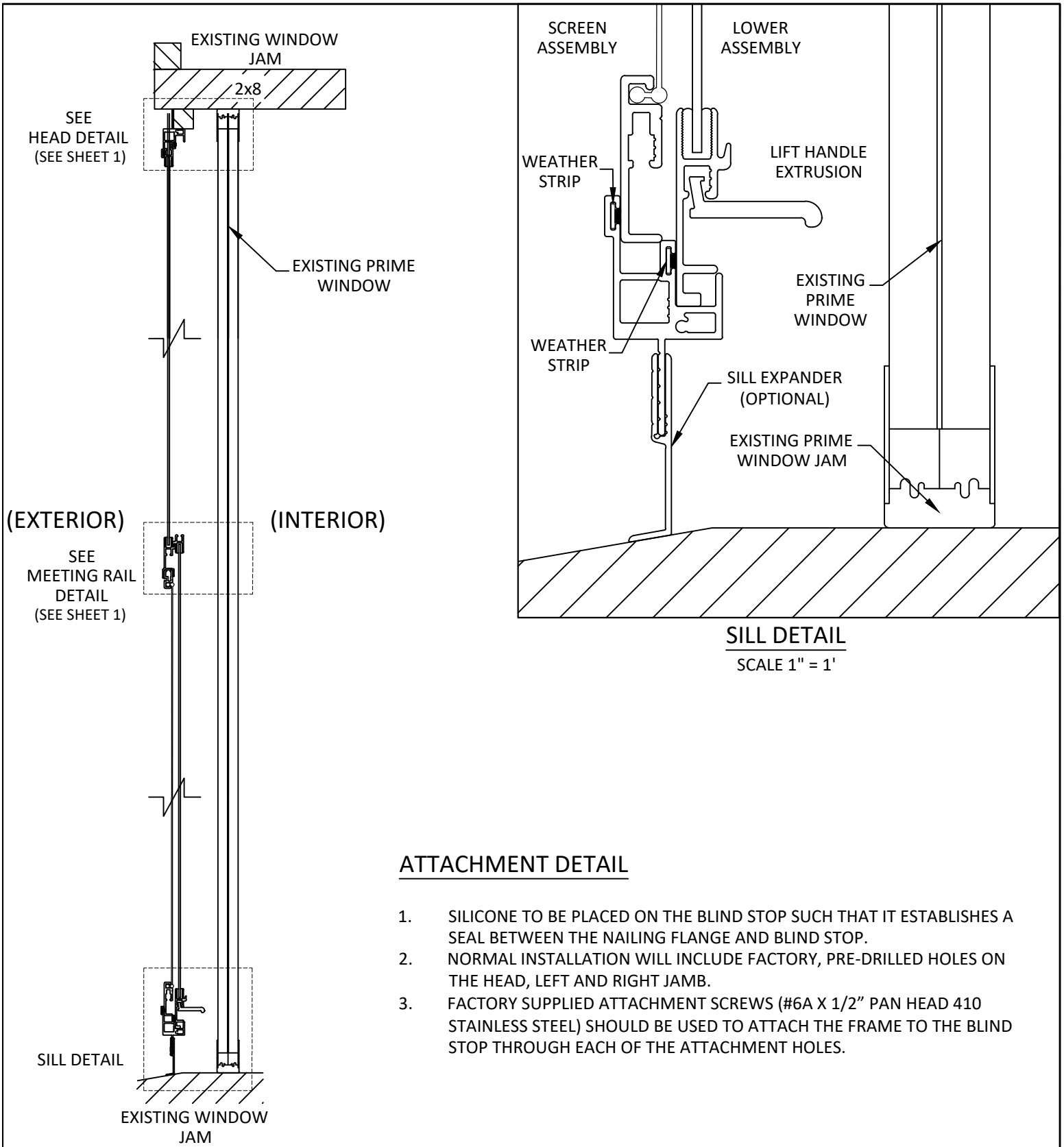

**ATTACHMENT DETAIL**

1. SILICONE TO BE PLACED ON THE BLIND STOP SUCH THAT IT ESTABLISHES A SEAL BETWEEN THE NAILING FLANGE AND BLIND STOP.
2. NORMAL INSTALLATION WILL INCLUDE FACTORY, PRE-DRILLED HOLES ON THE HEAD, LEFT AND RIGHT JAMB.
3. FACTORY SUPPLIED ATTACHMENT SCREWS (#6A X 1/2" PAN HEAD 410 STAINLESS STEEL) SHOULD BE USED TO ATTACH THE FRAME TO THE BLIND STOP THROUGH EACH OF THE ATTACHMENT HOLES.

**QUANTAPANEL®**

QP704-DH INSULATING GLASS SYSTEM  
 DETAIL SHEET 2 - INSTALLED

NOTES:

DATE  
 08/04/2020

SCALE  
 1" = 5'

DRAWN BY  
 R.A.S.